



WHITEHORNS

Buy. Sell. Let. Relax!

0114 268 8533
info@whitehorns.com
www.whitehorns.com



68 Broxholme Road, Woodseats

Sheffield

Offers in Region of **£190,000**

68 Broxholme Road

Woodseats, Sheffield

This beautifully presented two double bedroom mid-terraced property is ideally situated in a fantastic location close to a wealth of shops, pubs, and cafes. The home offers a modern and stylish finish throughout, making it perfect for first time buyers or those seeking a move-in ready residence. The property benefits from a rear extension, providing additional living space, and is within easy reach of reputable local schools and excellent public transport links. With Graves Park just a short stroll away, residents can enjoy the best of both urban convenience and green open spaces. Outside to the rear is a private garden boasting stunning views and privacy and to the front is ample on street parking.

Council Tax band: A

Tenure: Leasehold

- TWO DOUBLE BEDROOMED MID-TERRACED PROPERTY
- FANTASTIC LOCATION CLOSE TO A WELATH OF SHOPS, PUBS AND CAFES
- CLOSE TO GRAVES PARK
- EXTENSION TO THE REAR
- PRIVATE GARDEN WITH SUPERB VIEWS
- AMPLE FREE ON STREET PARKING
- PERFECT FOR FIRST TIME BUYERS
- REPUTABLE LOCAL SCHOOLS
- GREAT PUBLIC TRANSPORT LINKS
- MODERN AND STYLISH FINISH THROUGHOUT





Ground Floor

Approx. 31.0 sq. metres (333.5 sq. feet)

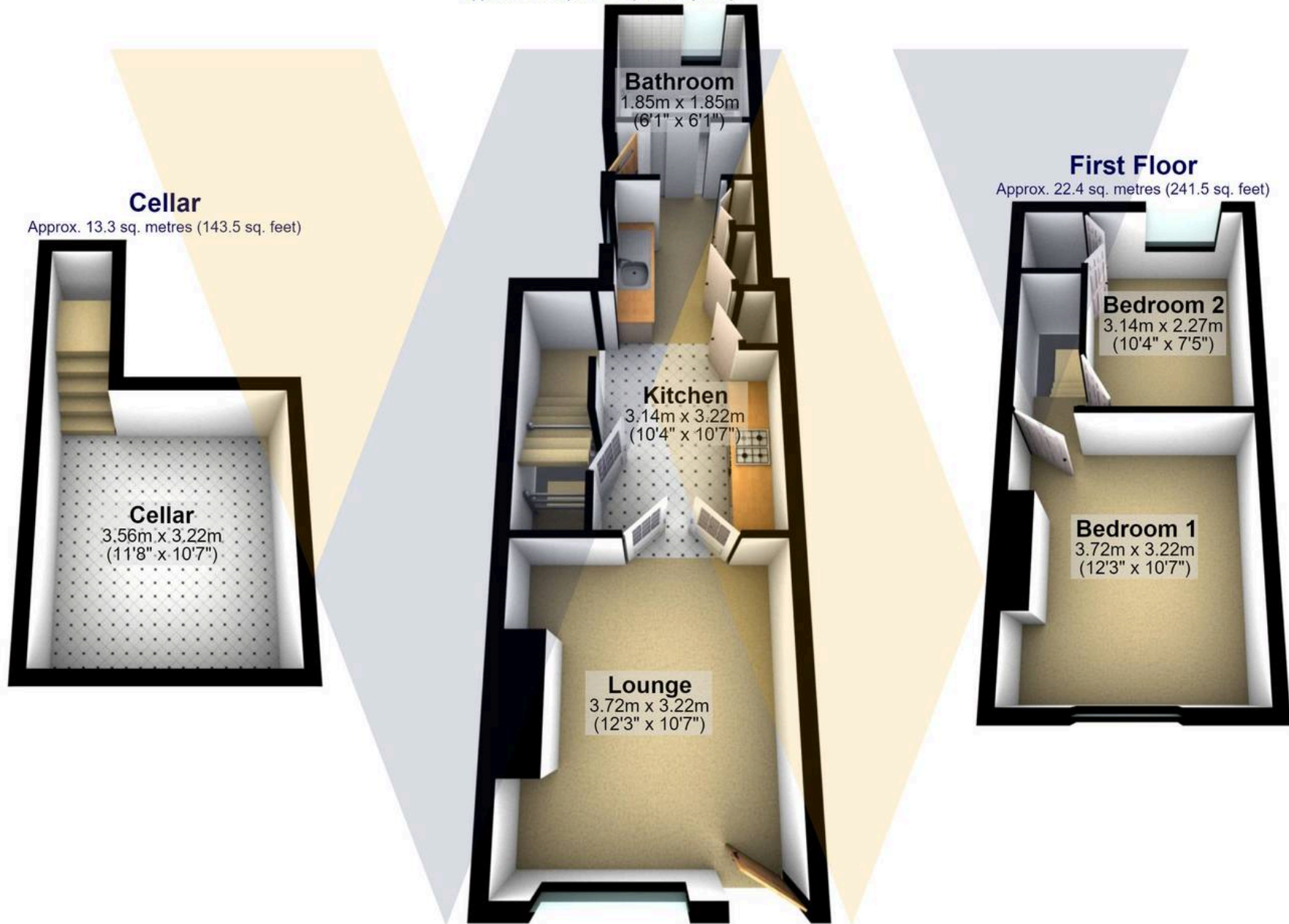

Total area: approx. 66.7 sq. metres (718.4 sq. feet)

All measurements are approximate
Plan produced using PlanUp.

68 Broxholme Road



WHITEHORNS

Buy. Sell. Let. Relax!

0114 268 8533
info@whitehorns.com
www.whitehorns.com