



WHITEHORSES

Buy. Sell. Let. Relax!

0114 268 8533
info@whitehorses.com
www.whitehorses.com



71 Bannerdale Road, Carter Knowle

Sheffield

Guide Price £315,000

71 Bannerdale Road

Carter Knowle, Sheffield

Located in the heart of ultra popular Carter Knowle is this tastefully presented and very well proportioned three bedroomed, bay windowed, semi detached family home. Offering super light and spacious accommodation across two floors currently number 71 offers vast as yet untapped potential to extend to the side, rear and loft (subject to planning) to create a forever home. With off road parking, garage and lovely rear private garden this property is pitch perfect for the growing family market and must be viewed to be fully appreciated. Falling within catchment for excellent local schools.

Council Tax band: C

Tenure: Leasehold

- THREE BEDROOMED SEMI DETACHED FAMILY HOME
- OFF ROAD PARKING GARAGE AND REAR GARDEN
- HEART OF ULTRA POPULAR CARTER KNOWLE
- CLOSE TO AMENITIES AND FASHIONABLE ABBEYDALE ROAD
- HUGE POTENTIAL TO EXTEND TO THE SIDE REAR AND LOFT SUBJECT TO PLANNING
- PERFECT FOR THE GROWING FAMILY MARKET
- OFSTED RATED EXCELLENT LOCAL SCHOOLING CATCHMENTS ON OFFER
- VIEWING ADVISED TO DO FULL JUSTICE
- CHELSEA AND MILLHOUSES PARKS CLOSE BY
- LEASEHOLD PROPERTY AND COUNCIL TAX BAND C



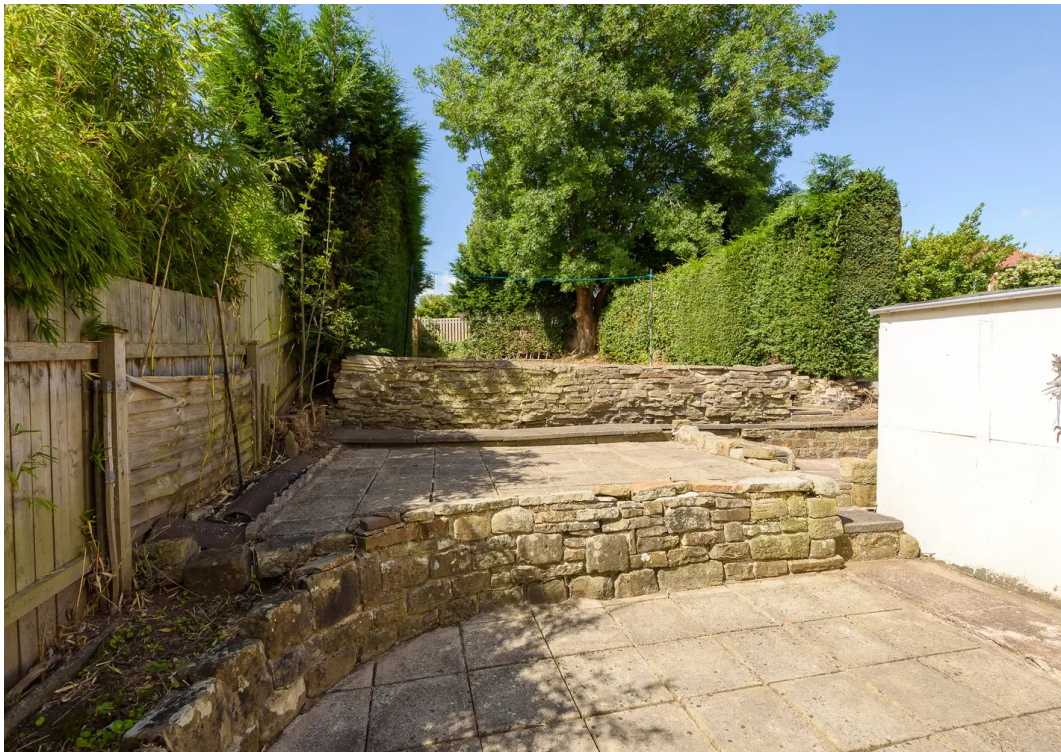

Garage
Approx. 10.0 sq. metres (107.2 sq. feet)



Garage
4.19m x 2.38m
(13'9" x 7'10")

Ground Floor

Approx. 39.5 sq. metres (425.4 sq. feet)

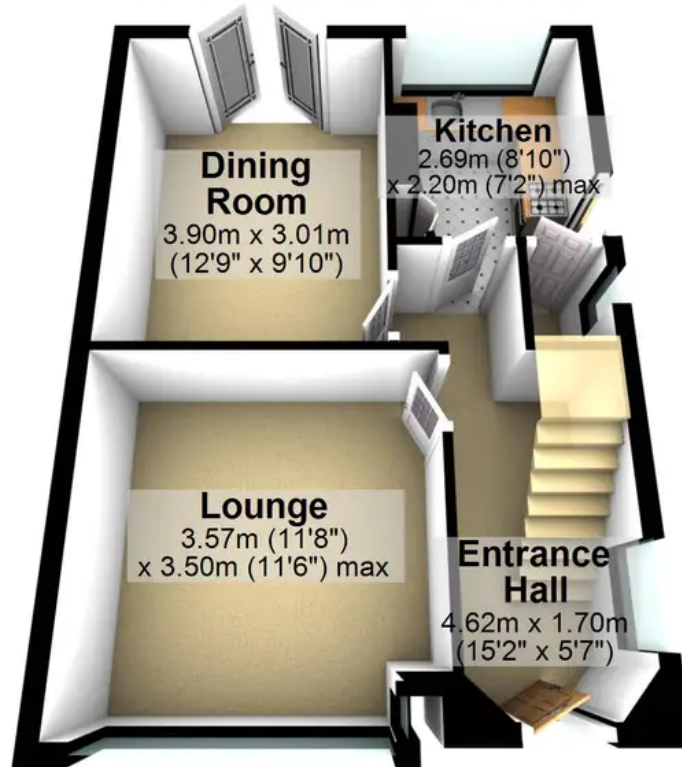

Dining Room
3.90m x 3.01m
(12'9" x 9'10")

Kitchen
2.69m (8'10")
x 2.20m (7'2") max

Lounge
3.57m (11'8")
x 3.50m (11'6") max

Entrance Hall
4.62m x 1.70m
(15'2" x 5'7")

First Floor

Approx. 38.8 sq. metres (418.1 sq. feet)



Bedroom 2
3.90m x 3.01m
(12'9" x 9'10")

Bedroom 3
2.69m (8'10") max
x 2.20m (7'2")

Bedroom 1
3.57m (11'8")
x 3.50m (11'6") max

Bathroom

Landing

WC

Total area: approx. 88.3 sq. metres (950.6 sq. feet)

All measurements are approximate
Plan produced using PlanUp.