



WHITEHORSES
Buy. Sell. Let. Relax!
0114 268 8533
info@whitehorses.com
www.whitehorses.com

175 Lowedges Crescent, Lowedges

Sheffield

Offers in Region of **£160,000**

175 Lowedges Crescent

Lowedges, Sheffield

Perfect for first time buyers and investors alike is this deceptively spacious and modern three bedroomed mid-terraced family home. Being located in the heart of the popular suburb of Lowedges with fantastic view of Greenhill and coal Aston from the front aspect of the property. This property offers a versatile range of accommodation that would suit any buyer and briefly consists of an entrance hallway, lounge, kitchen dining room, two double bedrooms, single bedroom and a family bathroom. To the rear is a enclosed private garden perfect for families and those with pets.

Council Tax band: A

Tenure: Freehold

- PERFECT FOR THE YOUNG FAMILY, FIRST TIME BUYER OR PROFESSIONAL COUPLE
- LARGE SPACIOUS LIVING ROOM AND KITCHEN
- HEART OF POPULAR LOWEDGES WITH EASY ACCESS TO MOTORWAY NETWORKS
- THREE BEDROOMED MID TERRACED PROPERTY TOTALLING 798 SQ FT
- CLOSE TO A WEALTH OF LOCAL AMENITIES
- TOP LOCAL SCHOOLING CATCHMENTS INCLUDING MEADOWHEAD SCHOOL
- ENCLOSED FRONT AND REAR GARDEN WITH HUGE POTENTIAL
- LOCAL GREENHILL PARK ON ITS DOORSTEP
- NO ONWARD CHAIN
- FREEHOLD PROPERTY AND COUNCIL TAX BAND A





Ground Floor

Approx. 37.0 sq. metres (398.4 sq. feet)

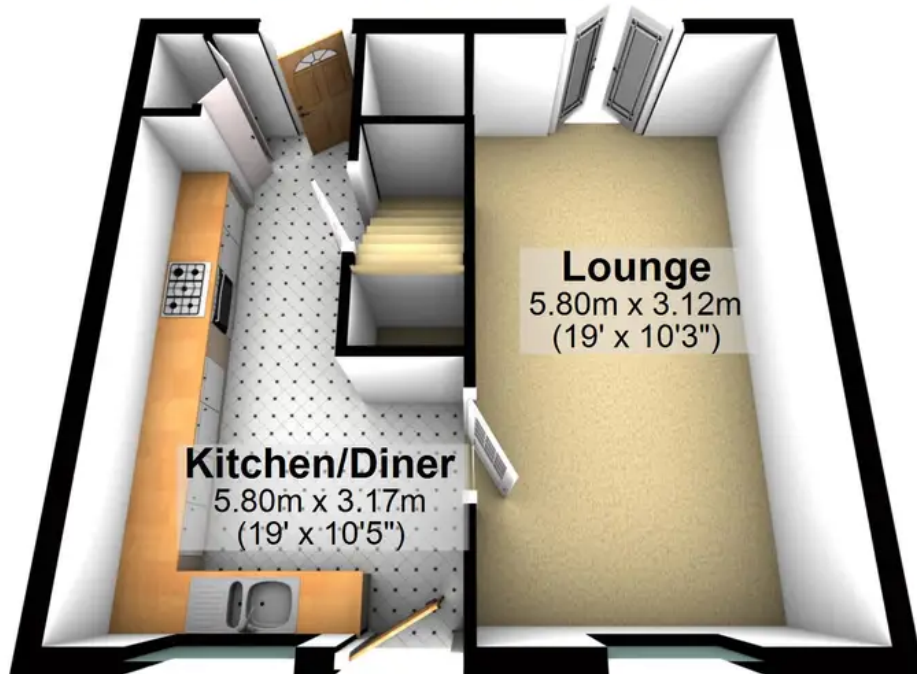

First Floor

Approx. 37.1 sq. metres (399.7 sq. feet)

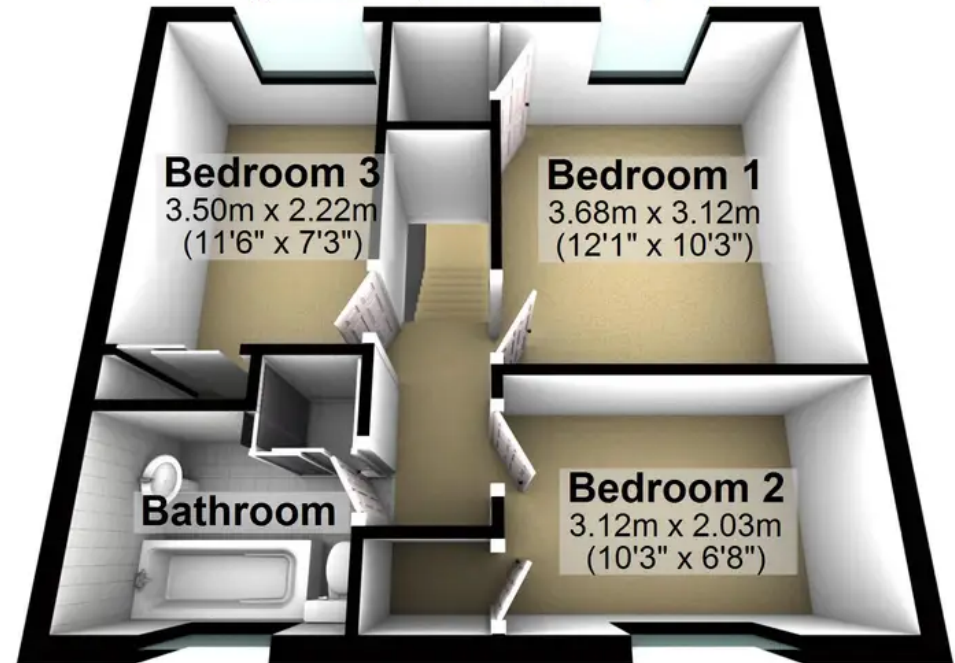

Total area: approx. 74.1 sq. metres (798.1 sq. feet)

All measurements are approximate
Plan produced using PlanUp.