



WHITEHORNS

Buy. Sell. Let. Relax!

0114 268 8533
info@whitehorns.com
www.whitehorns.com

45 Longford Crescent, Bradway

Guide Price £425,000 - £450,000

45 Longford Crescent

Bradway, Sheffield

An absolutely fabulous three/four bedroom semi detached family home. Having been tastefully extended to the side, rear and loft to create a unique layout that offers a huge degree of flexibility and could be transformed if required to self contained annexe incorporating the existing attached garage. With three impressive floors of accommodation that total 1,631 sq feet this lovely home is ideally suited to the growing family market looking for a forever home. Quietly tucked away on this super popular residential road within the very heart of Bradway on the south west of the city. Enjoying some impressive views to the front over The Peak District, wonderful, rear private garden and ample off road parking to the front it's easy to say that viewing is absolutely essential to fully appreciate the size and style on offer.

Council Tax band: D

Tenure: Freehold

- FABULOUS THREE/FOUR BEDROOMED SEMI DETACHED
- TASTEFULLY EXTENDED TO THE SIDE REAR AND LOFT
- FLEXIBLE ACCOMMODATION ACROSS THREE FLOORS TOTALLING 1,631 SQ FT
- PERFECT FOR THE GROWING FAMILY MARKET
- EXCELLENT LOCAL SCHOOL CATCHMENTS
- IMPRESSIVE VIEWS OVER THE PEAK DISTRICT
- HEART OF ULTRA POPULAR BRADWAY ON THE SOUTH WEST OF THE CITY
- VIEWING ESSENTIAL TO FULLY APPRECIATE THE SIZE AND STYLE ON OFFER
- VERSATILE ACCOMMODATION WITH POTENTIAL TO CREATE AN ANNEXE IF REQUIRED
- FREEHOLD PROPERTY AND COUNCIL TAX BAND D





Ground Floor
Approx. 85.1 sq. metres (916.3 sq. feet)

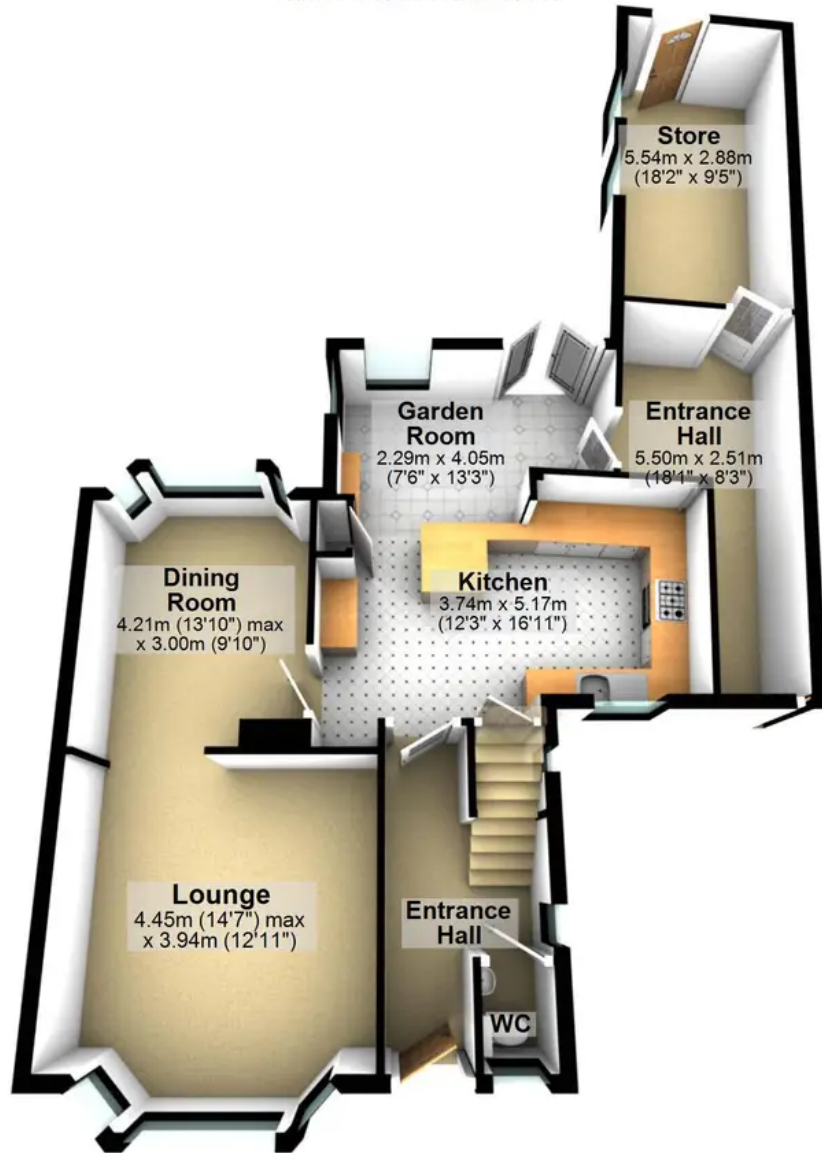

First Floor
Approx. 43.6 sq. metres (469.3 sq. feet)

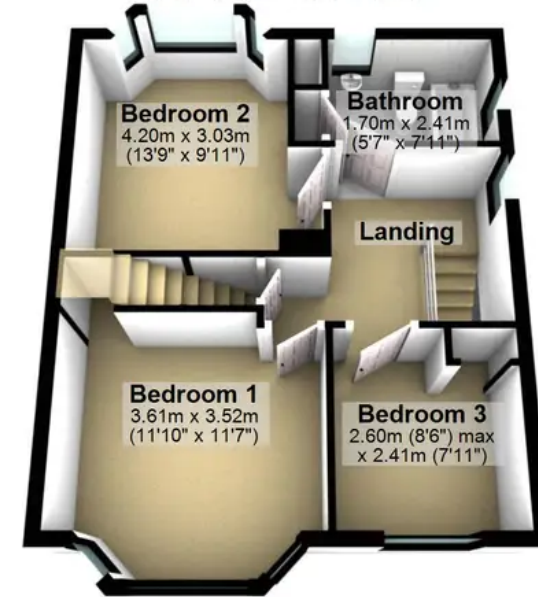

Second Floor
Approx. 22.9 sq. metres (246.1 sq. feet)

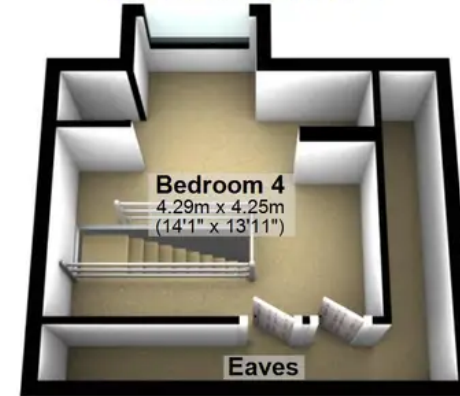

Total area: approx. 151.6 sq. metres (1631.7 sq. feet)

All measurements are approximate
Plan produced using PlanUp.