



**WHITEHORNES**

Buy. Sell. Let. Relax!

0114 268 8533  
info@whitehorses.com  
www.whitehorses.com

**Top Farm, College Road**

Sheffield

Offers in Region of £985,000



# Top Farm

College Road, Sheffield

A once in a lifetime opportunity has arisen to purchase this truly stunning, immaculately presented and very deceptive, seven bedroom, four bathroom, detached farmhouse. Constructed from natural stone the property has been expertly finished to the very highest of standards by the current vendors with absolutely no expense spared. Retaining the original character and charm associated with a property from this era and effortlessly blending them with a cool, contemporary vibe that is pitch perfect for the growing family market. Accessed via a private drive and set in mature private landscaped grounds together with some far reaching views over the open fields, the property also benefits from a double garage, ample parking and numerous out buildings. With three incredible floors of sumptuous accommodation that total an impressive 3,493 sq feet framed by the beautiful open plan kitchen living diner and a master suite that oozes a boutique style with walk in dressing room and bespoke en-suite. Council Tax band: G

Tenure: Freehold

- ONCE IN A LIFETIME OPPORTUNITY TO PURCHASE A PROPERTY OF THIS STYLE AND SIZE
- SEVEN BEDROOMS AND FOUR BATHROOMS INCLUDING THREE EN-SUITES
- STONE BUILT DETACHED FARM HOUSE SET IN MATURE PRIVATE LANDSCAPED GROUNDS
- 3,439 SQ FEET OF INCREDIBLE ACCOMMODATION ACROSS THREE IMPRESSIVE FLOORS
- FINISHED TO THE VERY HIGHEST OF STANDARDS BY THE CURRENT VENDORS WITH ABSOLUTELY NO EXPENSE SPARED

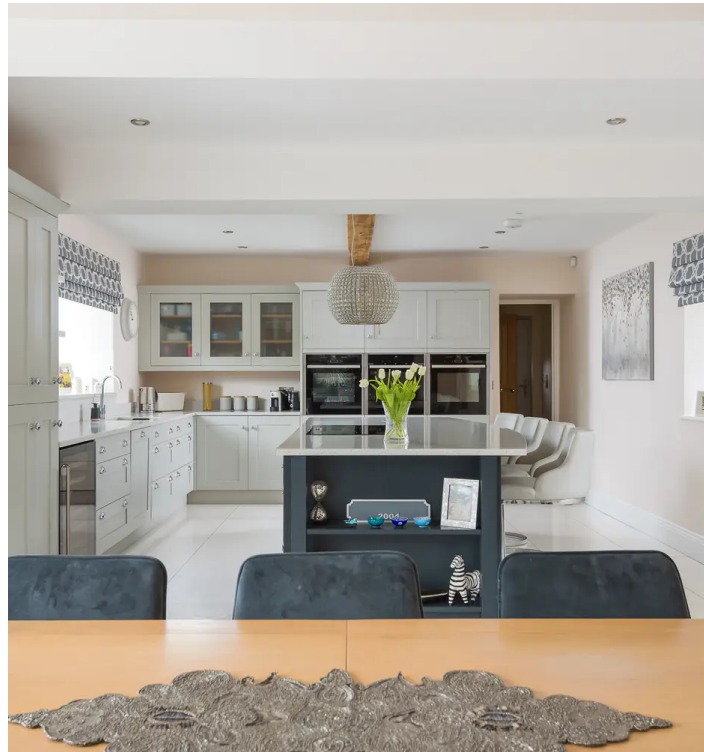







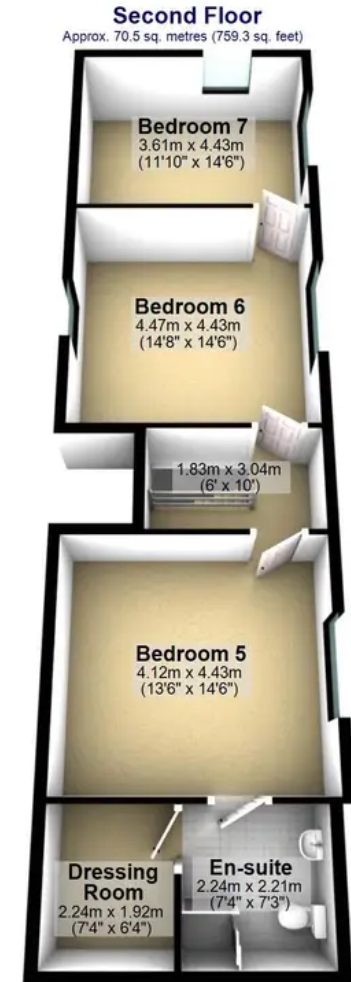
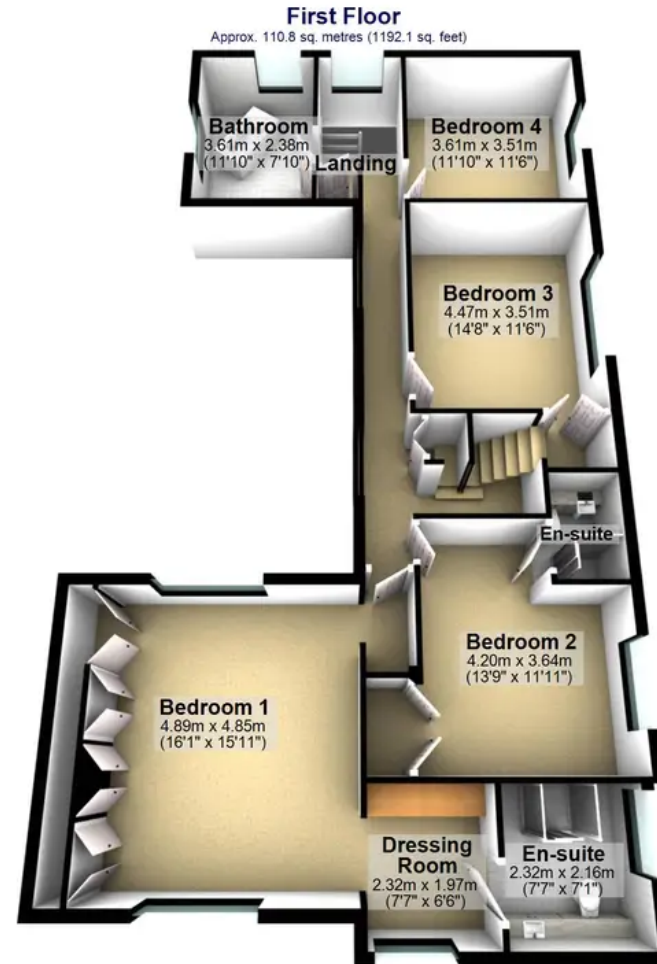
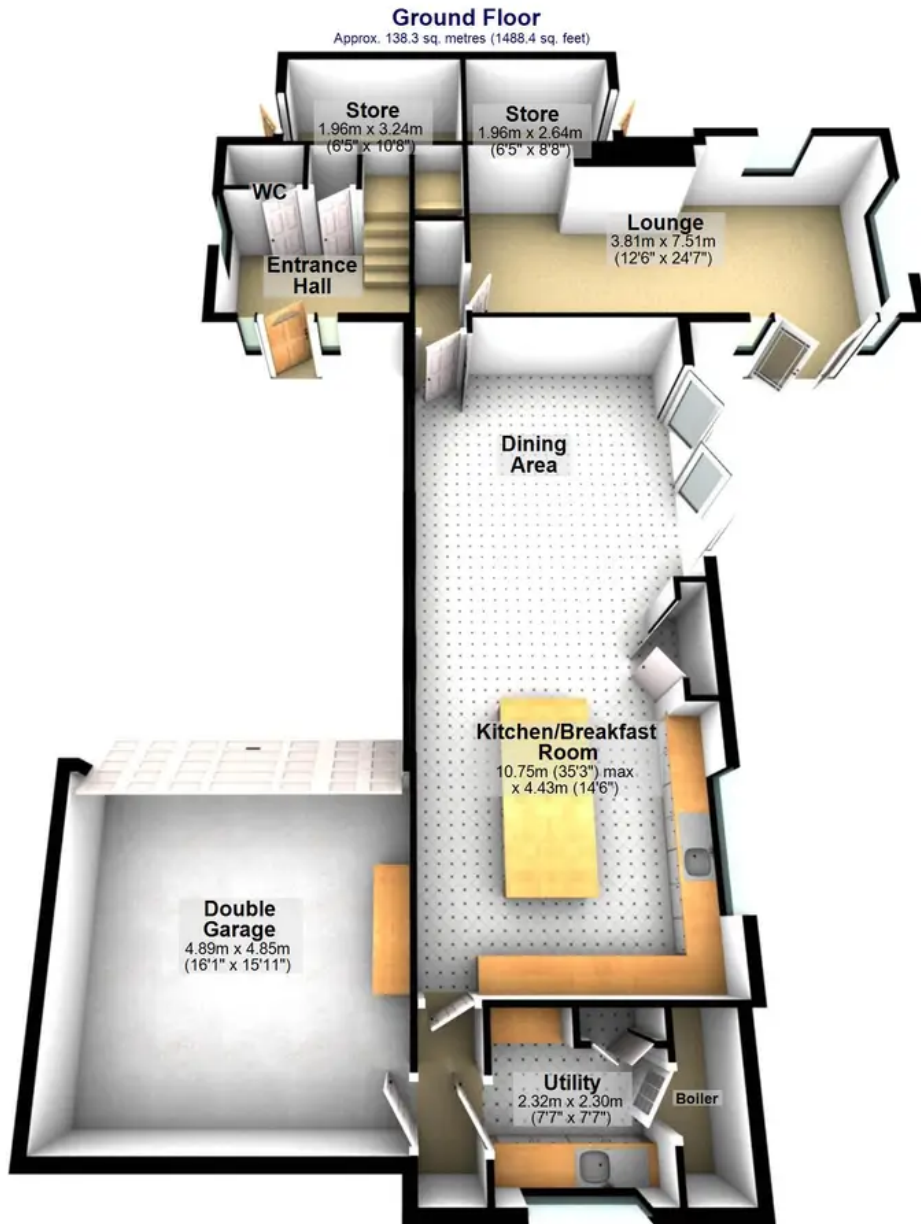

Total area: approx. 319.6 sq. metres (3439.8 sq. feet)

All measurements are approximate  
Plan produced using PlanUp.