



WHITEHORNES

Buy. Sell. Let. Relax!

0114 268 8533
info@whitehorns.com
www.whitehorns.com

50 Bankfield Road, Loxley

Sheffield

Guide Price £250,000 - £270,000

50 Bankfield Road

Loxley, Sheffield

Redefining the term contemporary open plan living is this simply stunning, immaculately presented and very deceptive three bedroom, mid town house style terraced. Having been transformed by the current vendors with absolutely no expense spared to create this breathtaking high end finish that benefits from a full re-wire, new central heating system including Hive home system, rendering to the front to name but a few new additions. With two impressive floors of accommodation framed by the open plan kitchen, living diner the property also boasts off road newly laid driveway, tandem garage, decked and landscaped rear garden together with fabulous views over the valley to the front. Quietly tucked away on this cul-de-sac road away from the hustle and bustle yet within easy reach of numerous local amenities, excellent schooling catchments are available and not forgetting the Peak District is literally on the doorstep.

Council Tax band: B Tenure: Leasehold

- STUNNING THREE BEDROOM MID TOWNHOUSE STYLE TERRACE
- RECENTLY FINISHED TO AN EXCEPTIONALLY HIGH STANDARD WITH NO EXPENSE SPARED
- CONTEMPORARY OPEN PLAN VIBE TO KITCHEN LIVING DINER
- FABULOUS FRONT VIEWS OVER THE VALLEY
- LANDSCAPED SUN TRAP GARDEN DECKED AREA DRIVEWAY AND TANDEM GARAGE
- SPACIOUS LIGHT AND VERSATILE ACCOMMODATION WITH POTENTIAL TO CONVERT THE GARAGE
- PERFECT FOR THE PROFESSIONAL COUPLE FIRST TIME BUYER OR YOUNG FAMILY ALIKE
- VIEWING ABSOLUTELY ESSENTIAL TO SEE THE FINISH ON OFFER



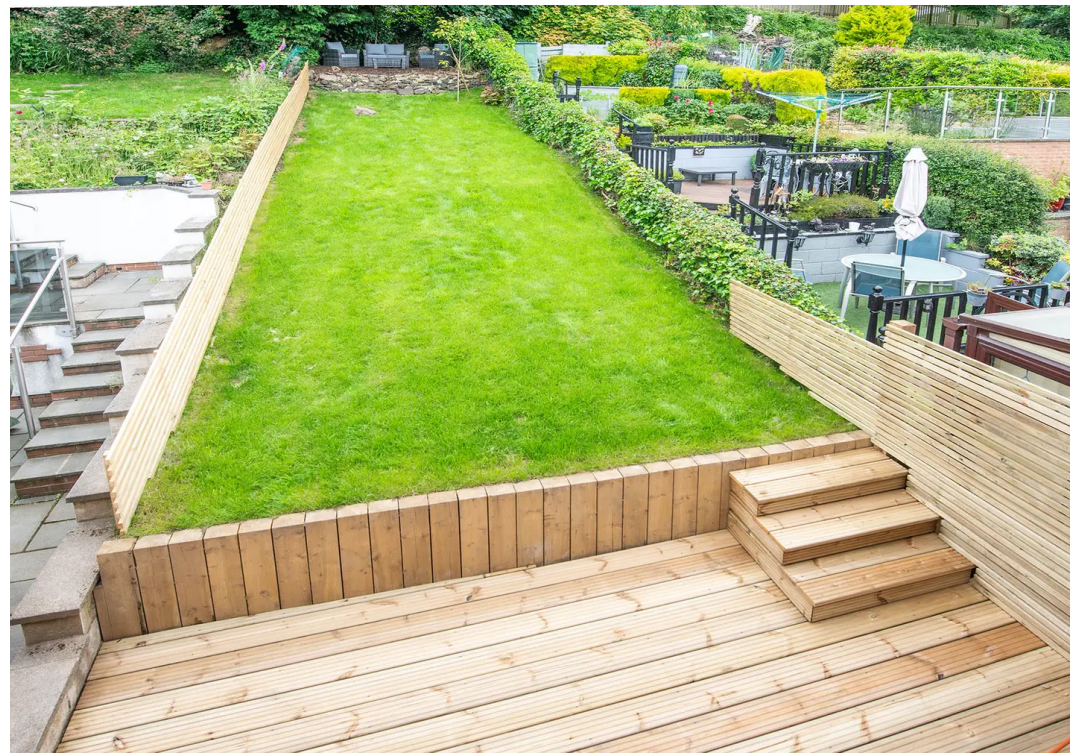

Ground Floor

Approx. 34.0 sq. metres (365.7 sq. feet)

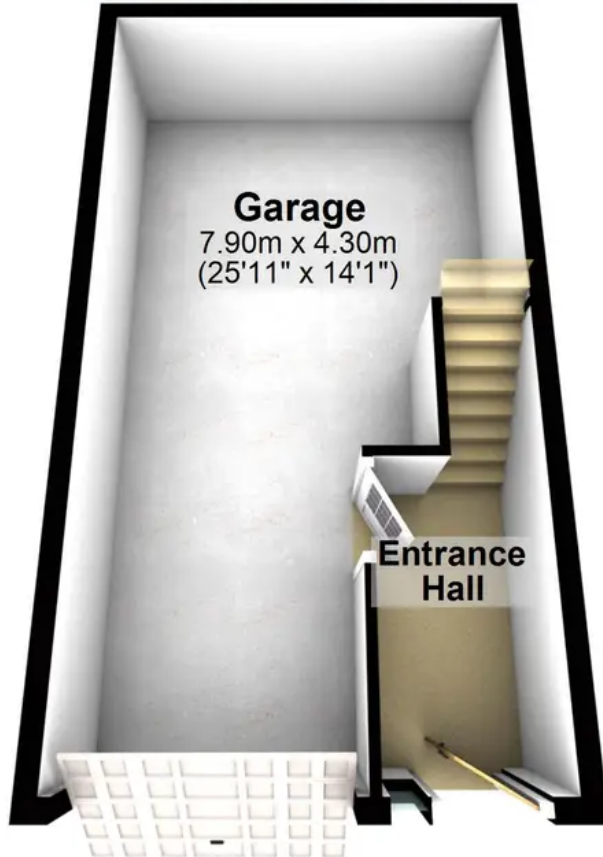

First Floor

Approx. 34.0 sq. metres (365.7 sq. feet)

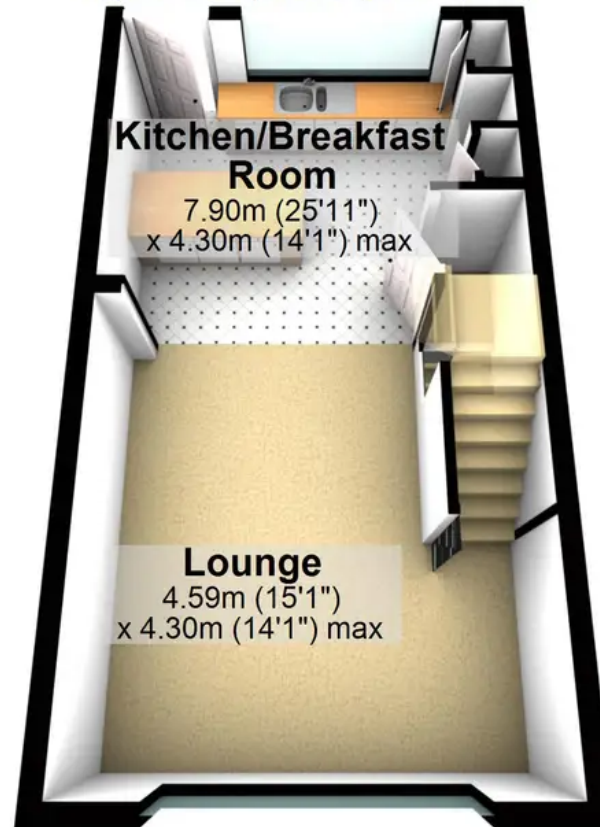

Second Floor

Approx. 34.0 sq. metres (365.7 sq. feet)

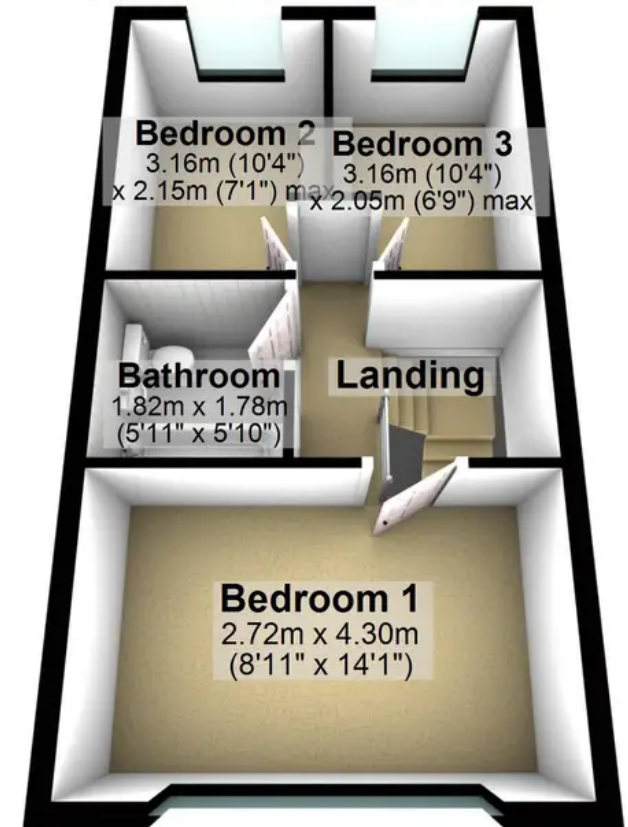

Total area: approx. 101.9 sq. metres (1097.2 sq. feet)

All measurements are approximate
Plan produced using PlanUp.