



WHITEHORNES

Buy. Sell. Let. Relax!

0114 268 8533
info@whitehorses.com
www.whitehorses.com

14 Greystones Crescent, Greystones

Sheffield

Guide Price £675,000 – £695,000

14 Greystones Crescent

Greystones, Sheffield

A truly unique and once in a lifetime opportunity has arisen to purchase this amazing four bedroom, two bathroom, semi detached family home. Standing in one of the largest plots within the area this incredible property offers full plans and planning permission for a separate two bedroom detached annexe bungalow within the garden, making it the perfect opportunity for those looking to cohabit with family or to create a work from home bespoke designated office space. The main property enjoys a tasteful rear and side extension and offers up two super light and spacious floors of accommodation that total an already impressive 2,182 sq feet framed by a rear kitchen/diner. Being of particular interest to the growing family market this versatile property put simply must be viewed to reveal the true size and potential on offer. Quietly tucked away on this on this no through cul-de-sac within the heart of ultra popular Greystones and set within around a half acre of grounds that give a real feeling of privacy

Council Tax band: C Tenure: Leasehold

- A UNIQUE AND ONCE IN A LIFETIME OPPORTUNITY TO PURCHASE A PROPERTY OF THIS TYPE
- FULL PLANS AND PLANNING PERMISSION IN PLACE FOR A DETACHED TWO BEDROOM BUNGALOW IN THE GROUNDS
- TASTEFULLY EXTENDED TO THE SIDE AND REAR
- PERFECT FOR THE FAMILY LOOKING TO CO-HABIT WITH RELATIVES





Outbuilding

Approx. 11.8 sq. metres (127.0 sq. feet)

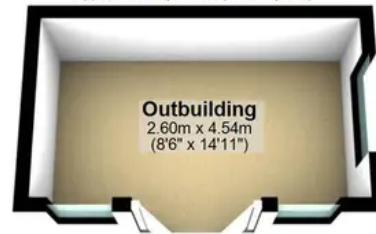

Ground Floor

Approx. 78.0 sq. metres (839.3 sq. feet)

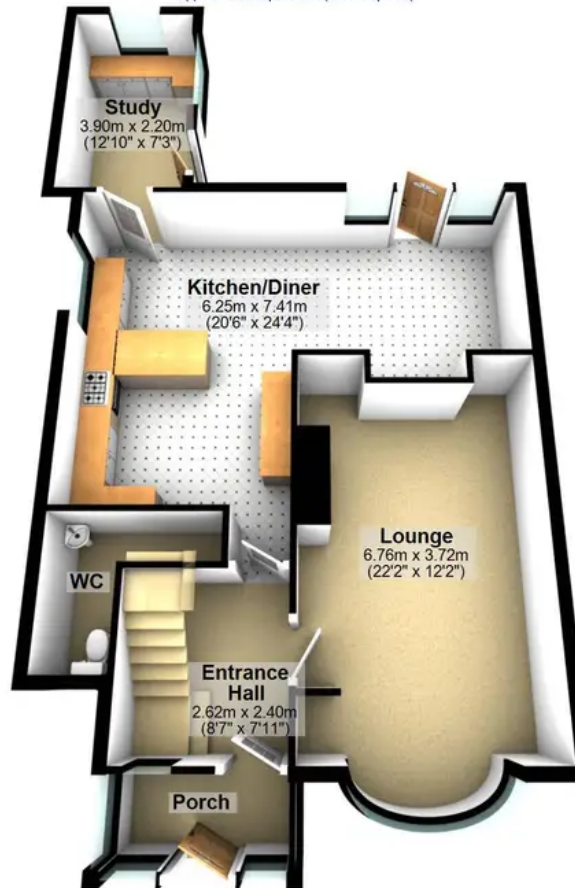

Basement

Approx. 56.4 sq. metres (607.2 sq. feet)

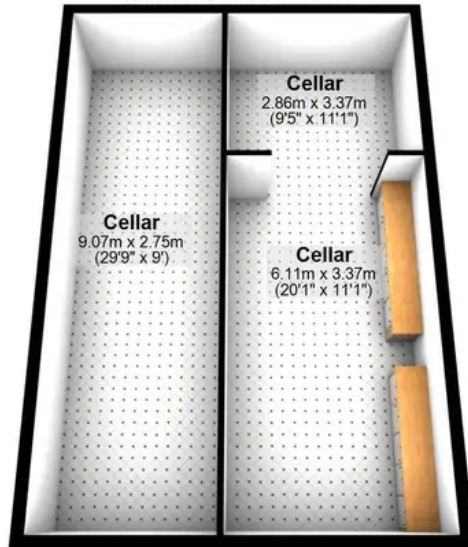

First Floor

Approx. 56.6 sq. metres (608.8 sq. feet)



Total area: approx. 202.7 sq. metres (2182.2 sq. feet)

All measurements are approximate
Plan produced using PlanUp.