



WHITEHORNS

Buy. Sell. Let. Relax!

0114 268 8533
info@whitehorns.com
www.whitehorns.com

46 Tylney Road, Norfolk Park

Sheffield

Offers in Region of **£250,000**

46 Tylney Road

Norfolk Park, Sheffield

Nestled in the heart of a sought-after location, this impressive four-bedroom mid-terraced house offers three floors of spacious accommodation totalling 1107 Sq. ft., making it ideal for a young family, first-time buyer, or professional couple. Located within the catchment area of local schooling options, including All Saints Catholic High School, Norfolk Community Primary School, Heritage Park School and The Sheffield College...

Council Tax band: A

Tenure: Leasehold

- FOUR BEDROOMED MID TERRACED PROPERTY
- THREE FLOORS OF SPACIOUS ACCOMMODATION TOTALLING 1107 SQ FT
- EASY AMPLE ON STREET PARKING
- REAR ENCLOSED GARDEN AND PATIO
- LOCAL SCHOOLING CATCHMENTS INCLUDING ALL SAINTS CATHOLIC HIGH SCHOOL
- EASY ACCESS TO NORFOLK PARK
- HEART OF THIS WELL SOUGHT AFTER LOCATION IN A QUIET POSITION
- CLOSE TO CENTRAL SHEFFIELD
- PERFECT FOR THE YOUNG FAMILY, FIRST TIME BUYER OR PROFESSIONAL COUPLE
- LEASEHOLD PROPERTY WITH 85 YEARS LEFT GROUND RENT £4.40 PER YEAR AND COUNCIL TAX BAND A £1516 P/A

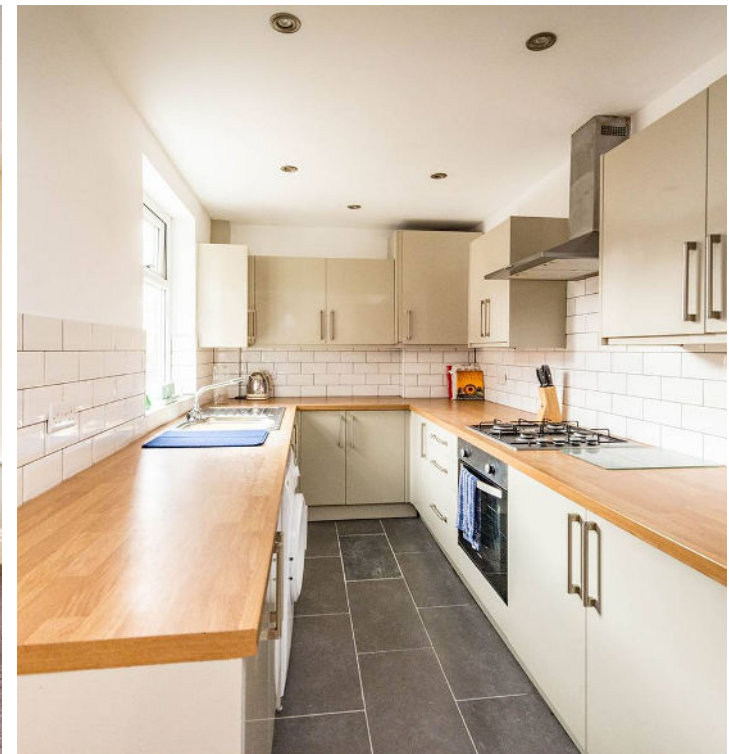



Ground Floor

Approx. 40.2 sq. metres (432.7 sq. feet)

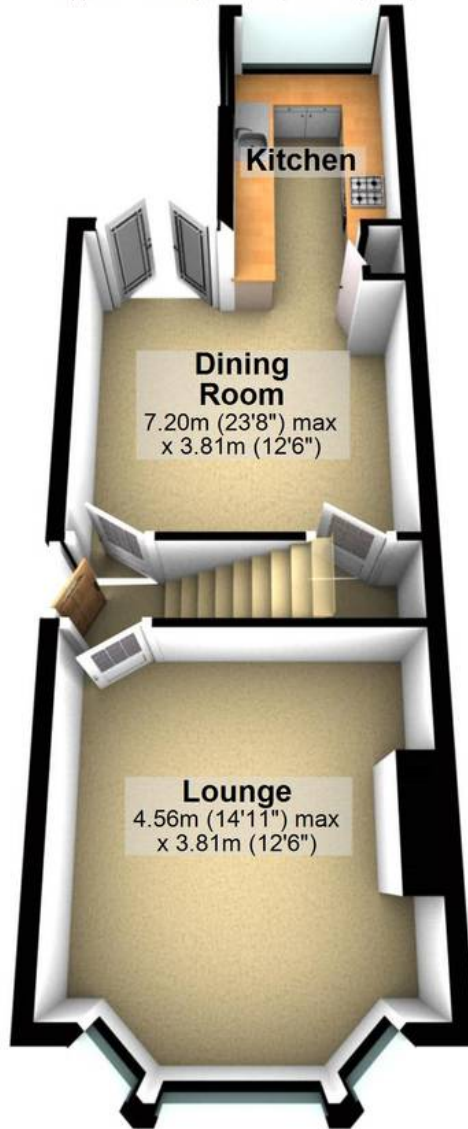

First Floor

Approx. 36.3 sq. metres (391.0 sq. feet)

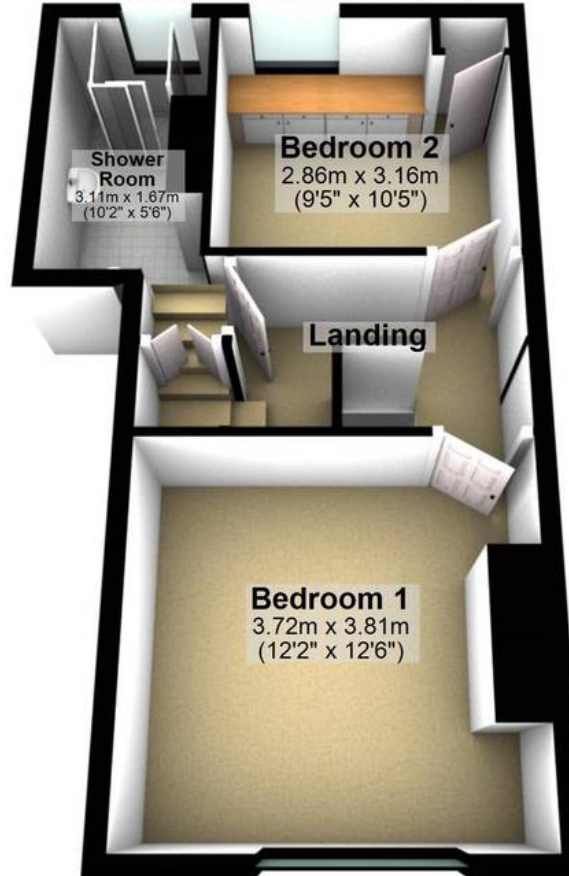

Second Floor

Approx. 26.4 sq. metres (283.7 sq. feet)

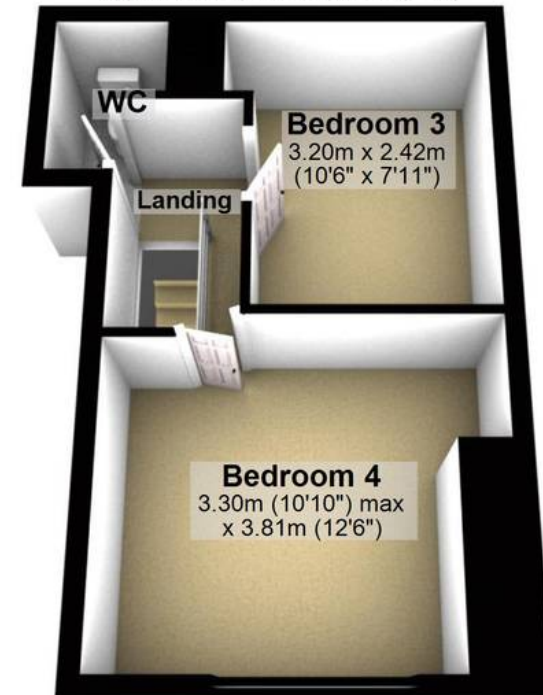

Total area: approx. 102.9 sq. metres (1107.5 sq. feet)

3 Bedroom Semi Detached House
Plan produced using PlanUp.