



WHITEHORNS

Buy. Sell. Let. Relax!

0114 268 8533
info@whitehorns.com
www.whitehorns.com



91 Westminster Avenue, Lodgemoor

Sheffield

Offers in Region of £150,000

91 Westminster Avenue

Lodgemoor, Sheffield

An incredibly deceptive one double bedroomed, ground floor apartment, with additional utility/office room. Finished internally to the very highest of standards internally by the current vendors its easy to say that viewing is absolutely essential to do full justice to see the finish and size on offer by this lovely property. The property is available with vacant possession making it ideal for the first time buyer, professional couple or those looking to downsize. Forming part of this established residential development in the very heart of ultra popular Lodge Moor. The apartment is on the very cusp of The Peak District but also offers up a wide variety of local amenities including principal hospitals and excellent public transport links. With communal parking to the front the property, gas central heating and intercom entrance the accommodation in brief comprises, entrance hall with storage, open plan sitting/dining room, separate kitchen, great sized double bedroom, bathroom and occasional office room. VALUER Andy Robinson Council Tax band: A

Tenure: Leasehold

- FABULOUS ONE BEDROOM GROUND FLOOR APARTMENT
- RECENTLY FINISHED TO A SUPER HIGH STANDARD BY THE CURRENT VENDORS
- AVAILABLE WITH NO UPWARD CHAIN INVOLVED AND VACANT POSSESSION
- PERFECT FOR THE THE FIRST TIME BUYER PROFESSIONAL COUPLE OR THOSE LOOKING TO DOWNSIZE
- HEART OF THIS UKTRA POPULAR RESIDENTIAL SUBURB OF LODGEMOOR





Ground Floor

Approx. 46.9 sq. metres (505.0 sq. feet)

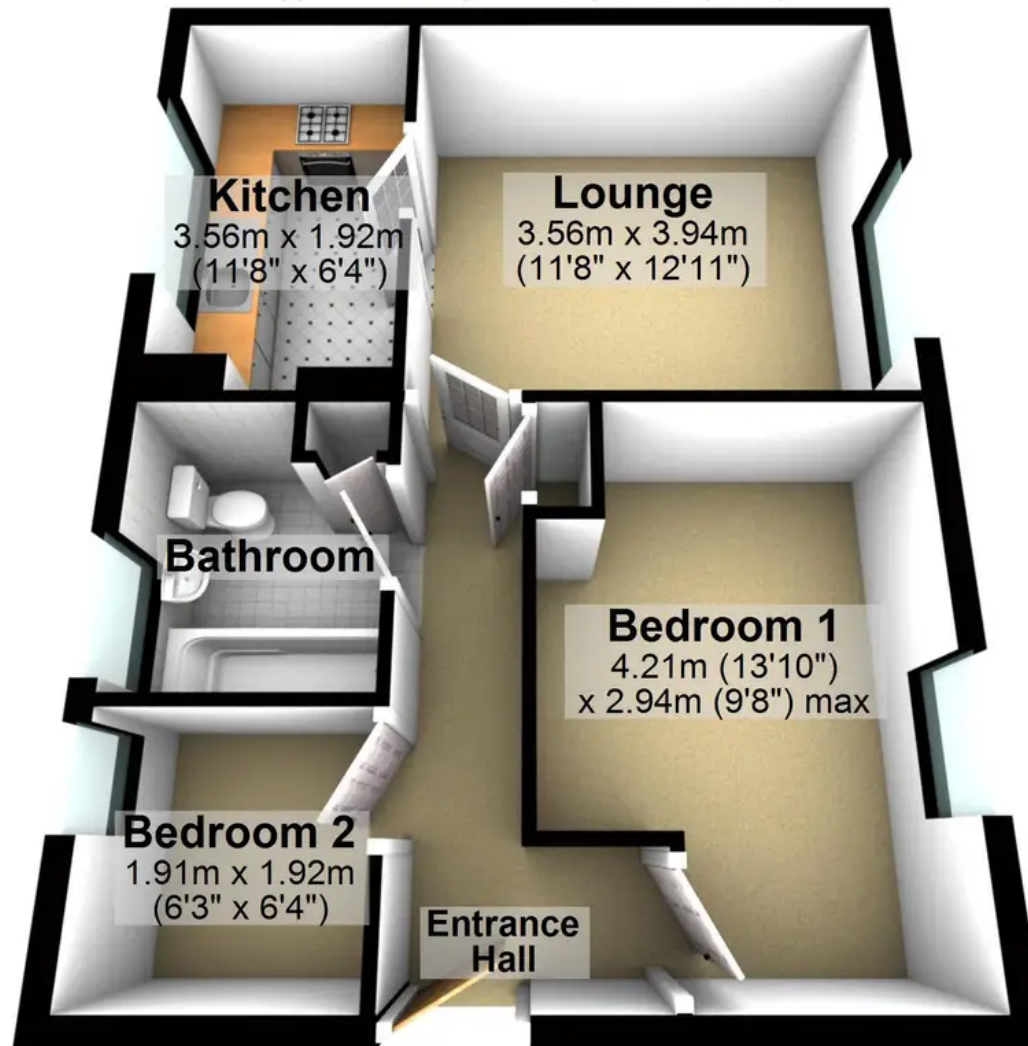

Total area: approx. 46.9 sq. metres (505.0 sq. feet)

All measurements are approximate
Plan produced using PlanUp.