



WHITEHORNS

Buy. Sell. Let. Relax!

0114 268 8533
info@whitehorns.com
www.whitehorns.com

277 Carter Knowle Road, Sheffield

Sheffield

Guide Price **£550,000**

277 Carter Knowle Road

Sheffield, Sheffield

An exceptionally rare opportunity has arisen to purchase this imposing, well presented and very well proportioned, three bedroomed, bay windowed detached family home. Standing in this larger than expected plot with expansive rear private garden, there is ample off road parking to the front and a garage to the side. Offering accommodation currently on two floors and with vast potential to further extend as neighbouring properties have already done so to the loft, rear and side (subject to planning) to create a forever family home. Enjoying a spacious and light feel throughout number 277 is designed perfectly for the growing family market and simply must be viewed internally to be fully appreciated. Ideally located in the heart of this popular suburb with not only competitive local schools but also a wealth local amenities within easy walking distance.

Council Tax band: D

Tenure: Freehold

- THREE BEDROOMED DEATCHED FAMILY HOME
- EXPANSIVE PRIVATE GARDENS
- REPUTABLE LOCAL SCHOOLS
- AMPLE OFF STREET PARKING
- GARAGE
- UTILITY ROOM AND DOWNSTAIRS WC
- TWO LARGE RECEPTION ROOMS
- CLOSE TO PEAK NATIONAL PARK
- OFFERED FOR SALE WITH NO ONWARD CHAIN
- MASSIVE SCOPE FOR EXPANSION





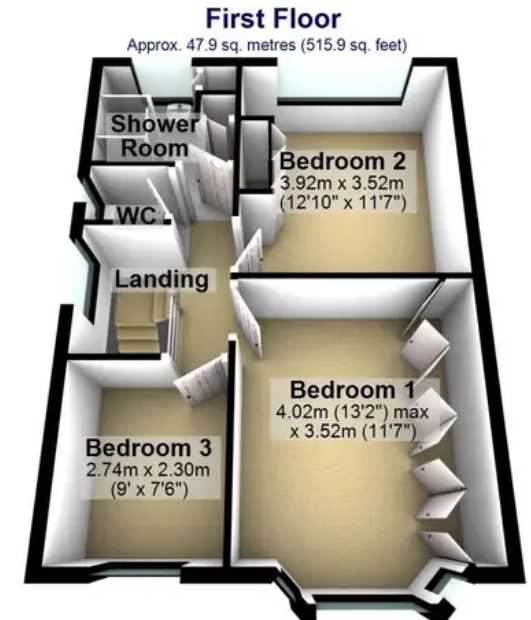
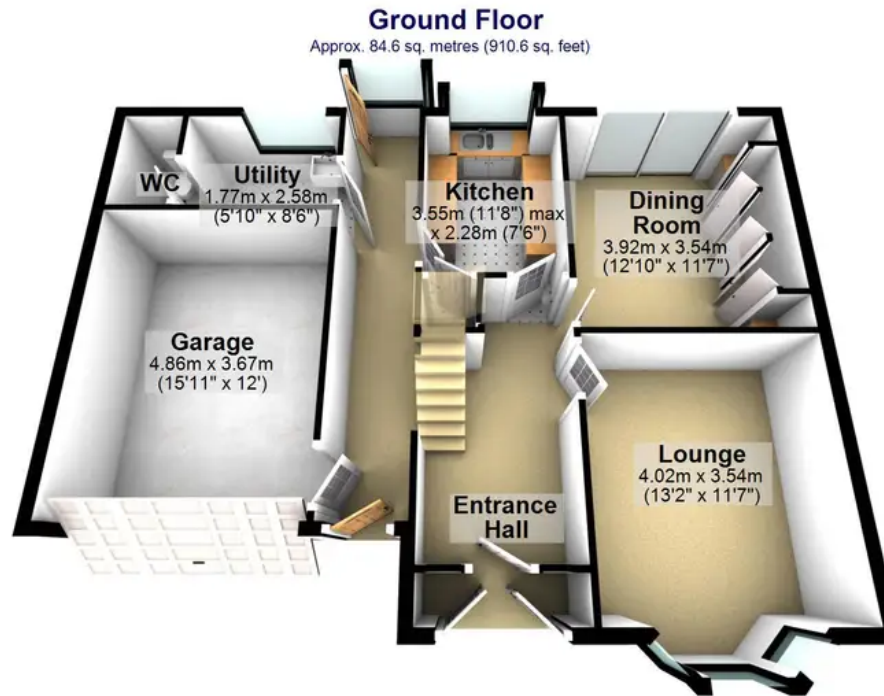
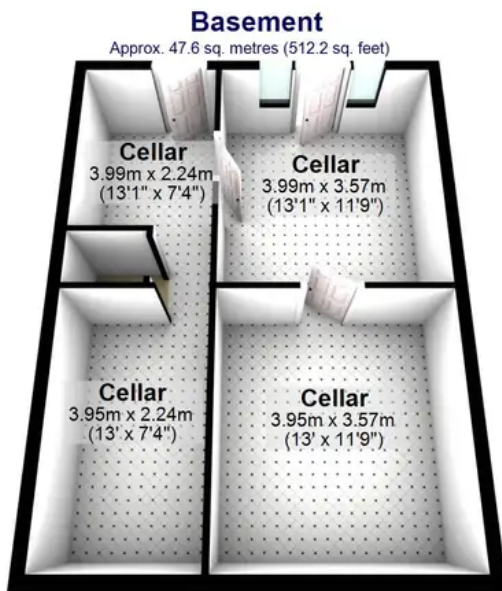

Total area: approx. 180.1 sq. metres (1938.6 sq. feet)

All measurements are approximate
Plan produced using PlanUp.