



WHITEHORNES

Buy. Sell. Let. Relax!

0114 268 8533
info@whitehorns.com
www.whitehorns.com



105a Harvey Clough Road, SHEFFIELD

Sheffield

Guide Price £150,000 - £160,000

105a Harvey Clough Road

SHEFFIELD, Sheffield

Perfect for first time buyers professional couple or those looking to down size alike is this spacious and beautifully well presented two double bed roomed first floor apartment. Having recently been finished to a super high standard by the current vendor with a newly fitted modern kitchen and bathroom together with offering an incredibly light and spacious feel throughout. Enjoying some lovely views and ideally located in the heart of the popular residential suburb of Norton Lees that offers up a wealth of local amenities on the door step as well great public transport links, The Peak District is literally up the road and Graves Park within easy walking distance. With use of the communal grounds, number 105 A also benefits from a private lock up single garage and good sized carpark. Offered to the open market with the benefit of no upward chain and vacant possession.

Council Tax band: A Tenure: Leasehold

- FABULOUS TWO DOUBLE BEDROOM FIRST FLOOR APARTMENT
- PRIVATE LOCK UP SINGLE GARAGE AND CAR PARK TO THE SIDE
- FINISHED INTERNALLY TO A REALLY HIGH STANDARD BY THE CURRENT VENDOR
- AVAILABLE WITH NO ONWARD CHAIN AND VACANT POSSESSION ON COMPLETION
- PERFECT FOR THOSE LOOKING TO DOWN SIZE THE PROFESSIONAL COUPLE OR FIRST TIME BUYER ALIKE
- HEART OF ULTRA POPULAR NORTON LEES SUBURB
- EASY ACCESS TO GRAVES PARK
- NUMEROUS LOCAL AMENITIES WITHIN A SHORT STROLL INCLUDING PUBLIC TRANSPORT LINKS
- VIEWING ESSENTIAL TO SEE THE FINISH AND SIZE ON OFFER BY THIS LOVELY APARTMENT







WHITEHORNES

Buy. Sell. Let. Relax!

0114 268 8533
info@whitehornes.com
www.whitehornes.com

Approx. 58.5 sq. metres (629.7 sq. feet)

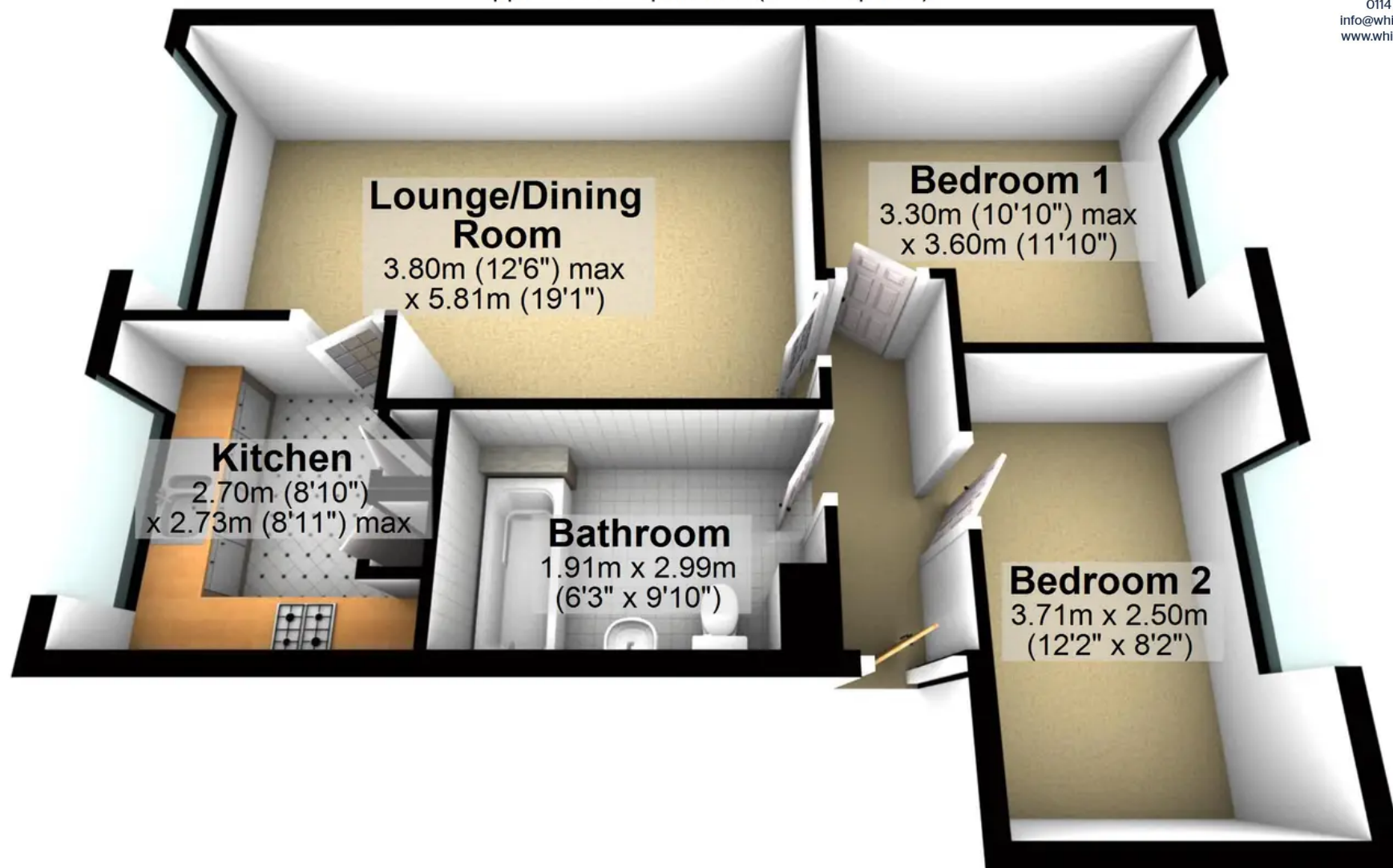

Total area: approx. 58.5 sq. metres (629.7 sq. feet)

All measurements are approximate
Plan produced using PlanUp.