



WHITEHORNES

Buy. Sell. Let. Relax!

0114 268 8533
info@whitehorns.com
www.whitehorns.com

1 Wath Road, Nether Edge

Sheffield

Guide Price £280,000 – £290,000

1 Wath Road

Nether Edge, Sheffield

An incredibly rare opportunity has arisen to purchase this substantial four bedroom, bay windowed, end Victorian terraced home. Offering vast potential to personalise the current property and in need of a scheme of general cosmetic updating but allowing the new buyer a blank canvas to start from it's easy to say that viewing is essential to fully appreciate the opportunity on offer. With three spacious and light floors of accommodation that total an impressive 1,604 sq feet together with a rear garden and easy on road parking and no chain involved. Located in the very heart of ultra popular Nether Edge on the south west of the city number 1 falls within catchment for excellent schools including Mercia secondary. The property also lies within a short stroll of fashionable Abbeydale Road and Nether Edge centre that offer up an array of independent cafes, eateries and shops together with Chelsea park and not forgetting The Peak District is on the doorstep. VALUER Andy Robinson

Council Tax band: A Tenure: Leasehold

- LARGE PERIOD FOUR BEDROOM END OF TERRACE
- IN NEED OF A SCHEME OF GENERAL UPDATING AND COSMETIC WORK
- THREE FLOORS OF ACCOMMODATION TOTALLING AN IMPRESSIVE 1,604 SQ FEET
- HEART OF ULTRA POPULAR NETHER EDGE WITH FASHIONABLE ABBEYDALE ROAD AMENITIES A SHORT STROLL
- EXCELLENT SCHOOLING CATCHMENTS INCLUDING MERCIA SECONDARY
- VIEWING ESSENTIAL TO SEE THE FULL POTENTIAL ON OFFER
- AVAILABLE WITH NO UPWARD CHAIN AND VACANT POSSESSION ON COMPLETION





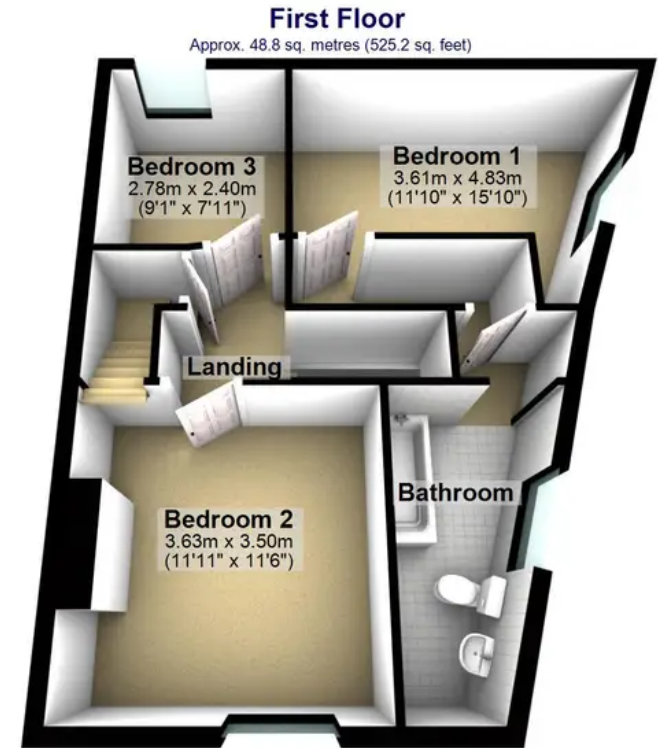
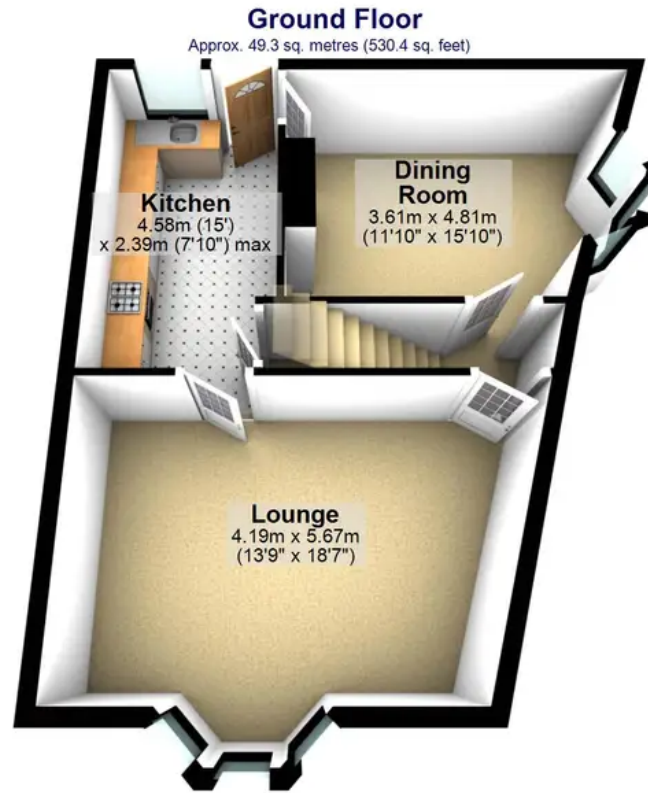
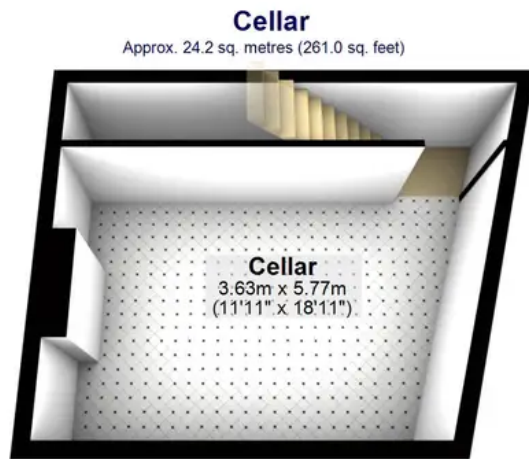

Total area: approx. 149.1 sq. metres (1604.8 sq. feet)

All measurements are approximate
Plan produced using PlanUp.



0114 268 8533
info@whitehorns.com
www.whitehorns.com