



WHITEHORSES

Buy. Sell. Let. Relax!

0114 268 8533
info@whitehorses.com
www.whitehorses.com

16 Ansell Road, High Storrs

Sheffield

Offers in Region of £385,000

16 Ansell Road

High Storrs, Sheffield

An incredible rare opportunity has arisen to purchase this lovely four bedroom, bay windowed, semi detached family home. Having been extended to the side over the garage already but allowing plenty of additional potential subject to planning to further extend to the rear and loft if required. Offering the new buyers a real blank canvas from which to start from and in need of a degree of modernisation but the opportunity is there to create a forever family home. With two spacious, light and versatile floors of accommodation that total an impressive 1,073 sq feet together with off road parking, garage and wonderful rear private family garden. Enjoying some incredible views to the rear towards Endcliffe park and the city skyline it's easy to say that this property will be particularly popular with the growing family market. Offered to the open market with the huge benefit of no upward chain and immediate vacant possession, number 16 is placed within the very heart of this ultra popular residential suburb of High Storrs on the south west

Council Tax band: C Tenure: Freehold

- FOUR BEDROOM EXTENDED BAY WINDOWED SEMI DETACHED FAMILY HOME
- HEART OF ULTRA POPULAR GREYSTONES SUBURB ON THE SOUTH WEST OF THE CITY
- OFF ROAD PARKING GARAGE AND LOVELY REAR PRIVATE GARDEN
- WONDERFUL VIEWS TO THE REAR TOWARDS CENTRAL SHEFFIELD AND BEYOND
- EXCELLENT SCHOOLING CATCHMENTS INCLUDING ECCLESALL JUNIORS AND HIGH STORRS SECONDARY
- AVAILABLE TO MARKET WITH NO UPWARD CHAIN AND VACANT POSSESSION





Ground Floor

Approx. 51.9 sq. metres (558.8 sq. feet)

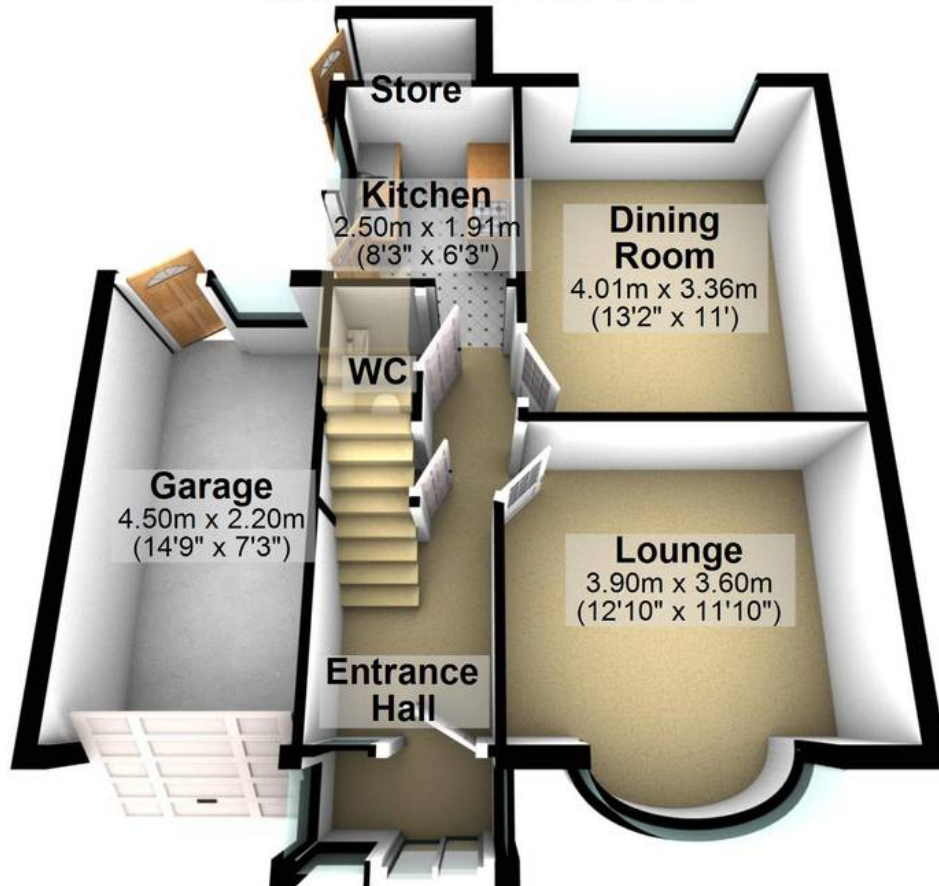

First Floor

Approx. 47.8 sq. metres (514.2 sq. feet)



Total area: approx. 99.7 sq. metres (1073.1 sq. feet)

All measurements are approximate
Plan produced using PlanUp.



WHITEHORNES

Buy. Sell. Let. Relax!

0114 268 8533
info@whitehornes.com
www.whitehornes.com