

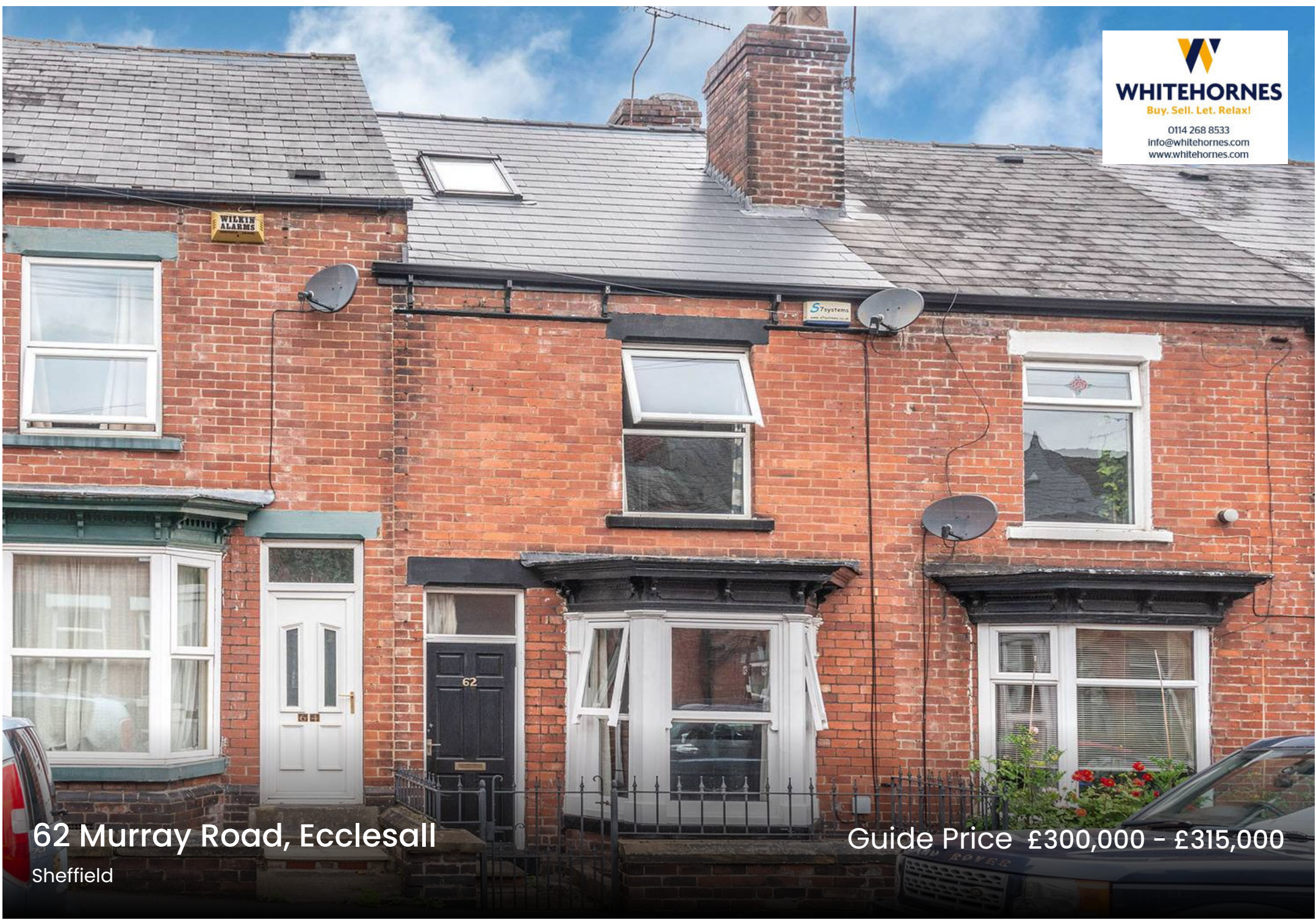

WHITEHORNES
Buy. Sell. Let. Relax!
0114 268 8533
info@whitehorns.com
www.whitehorns.com



62 Murray Road, Ecclesall
Sheffield

Guide Price £300,000 - £315,000

62 Murray Road

Ecclesall, Sheffield

Perfect for the professional couple, first time buyers and young family alike is this tastefully presented and very well proportioned three bedroom, bay windowed, Victorian terraced home. Offered to the market with the benefit of no onward chain and vacant possession it's easy to say that viewing is absolutely essential to fully appreciate the size and style on offer. With three impressive floors of accommodation, rear off shot kitchen that provides two reception rooms to the ground floor, private rear garden with no through fare from neighbouring properties together with on road parking to the front. Located on this super popular residential road within the heart of well sought after Ecclesall, excellent schooling catchments are on offer including both Greystones juniors and High Storrs secondary. Situated within a short stroll of both Endcliffe and Bingham parks, numerous independent cafes, eateries and cafes can be found at Banner Cross and fashionable Sharrow Vale.

Council Tax band: B Tenure: Leasehold

- EXCELLENT THREE BEDROOM BAY WINDOWED VICTORIAN TERRACED PROPERTY
- REAR OFF SHOT KITCHEN AND TWO RECEPTION ROOMS TO THE GROUND FLOOR
- HEART OF ULTRA POPULAR ECCLESALL CLOSE TO NUMEROUS LOCAL AMENITIES WITHIN BANNER CROSS AND FASHIONABLE SHARROW VALE
- TOP SCHOOLING CATCHMENTS INCLUDING GREYSTONES JUNIORS AND HIGH STORRS SECONDARY
- PERFECT FOR THE FIRST BUY OR FOR FOR THE YOUNG FAMILY MARKET
- AVAILABLE TO WITH THE HUGE BENEFIT OF NO UPWARD CHAIN AND VACANT POSSESSION





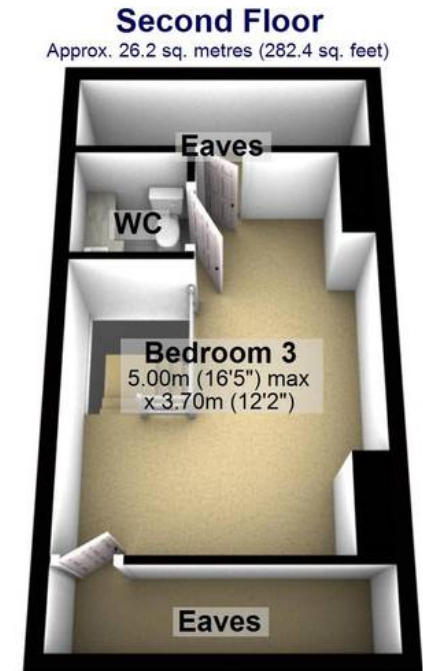
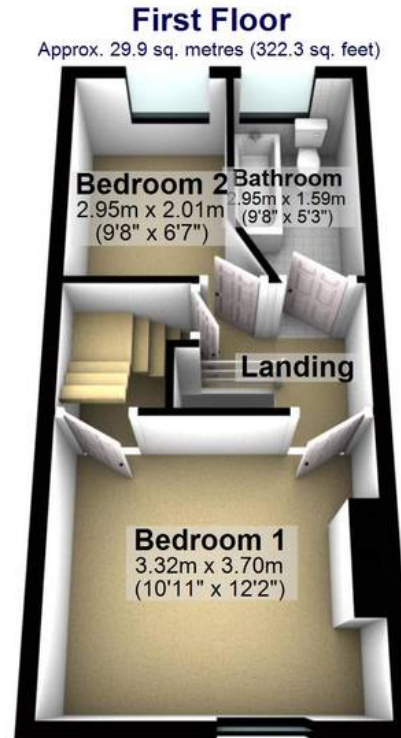
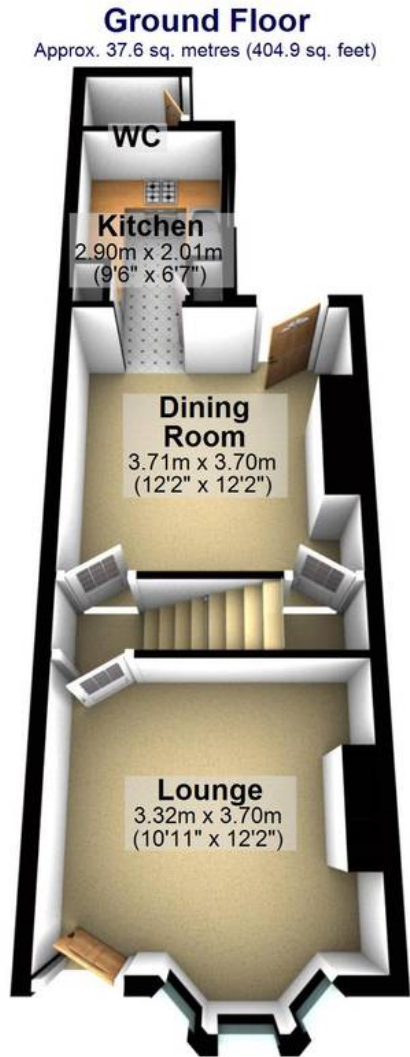
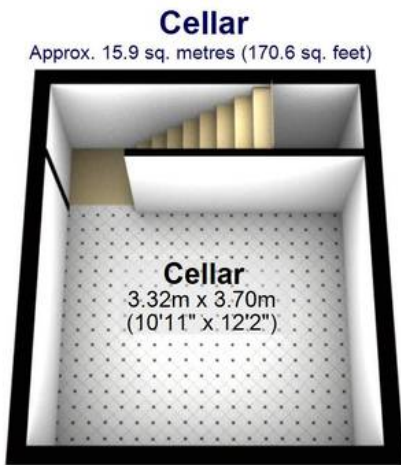

Total area: approx. 109.6 sq. metres (1180.2 sq. feet)

All measurements are approximate
Plan produced using PlanUp.