



WHITEHORNES

Buy. Sell. Let. Relax!

0114 268 8533
info@whitehorns.com
www.whitehorns.com

28 Blair Athol Road, Ecclesall

Sheffield

Offers in Region of £300,000

28 Blair Athol Road

Ecclesall, Sheffield

This excellent three-bedroom Victorian terraced property, located in the heart of the ultra-popular Ecclesall on the southwest of the city, is now available to the market with the benefit of no upward chain and vacant possession on completion. Positioned just a short stroll away from Ecclesall Road and Sharrow Vale, renowned for their array of independent cafes and eateries, this property offers the perfect blend of an urban lifestyle. Boasting excellent schooling catchments, including Greystones Juniors and High Storrs Secondary, this home is perfect for the first-time buyer, professional couple, or young family. With three spacious floors of accommodation totalling 847 sq feet, the property features an off-shot kitchen opening into the dining room, providing a seamless flow between the living spaces. Set within a short stroll of Endcliffe Park, principal hospitals and universities are also close by and not forgetting The Peak District is up the road. Furthermore, the property includes

Council Tax band: B Tenure: Leasehold

- EXCELLENT THREE BEDROOM VICTORIAN TERRACED PROPERTY
- AVAILABLE TO MARKET WITH THE BENEFIT OF NO UPWARD CHAIN AND VACANT POSSESSION ON COMPLETION
- SHORT STROLL TO ECCLESALL ROAD AND SHARROW VALE THAT OFFER AN ARRAY OF INDEPENDENT CAFES AND EATERIES
- EXCELLENT SCHOOLING CATCHMENTS





Ground Floor

Approx. 34.5 sq. metres (371.6 sq. feet)

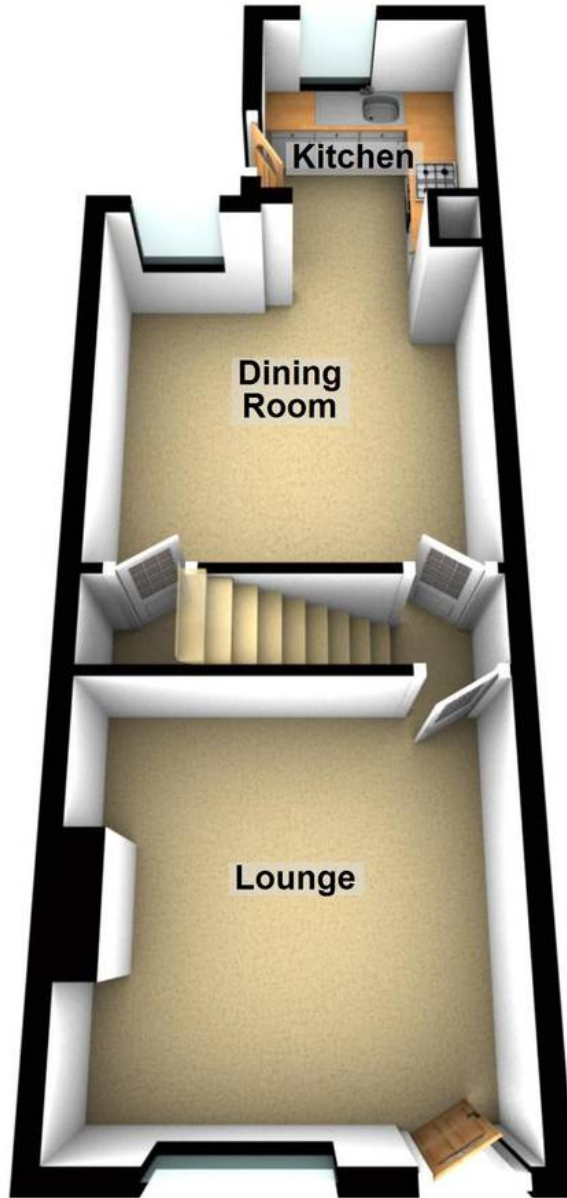

First Floor

Approx. 29.4 sq. metres (317.0 sq. feet)

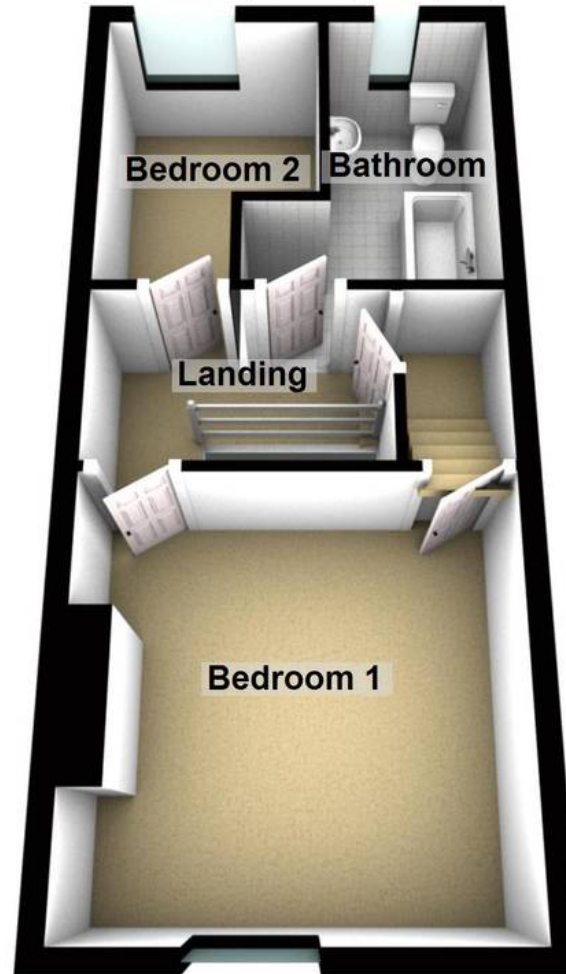

Second Floor

Approx. 14.7 sq. metres (158.4 sq. feet)

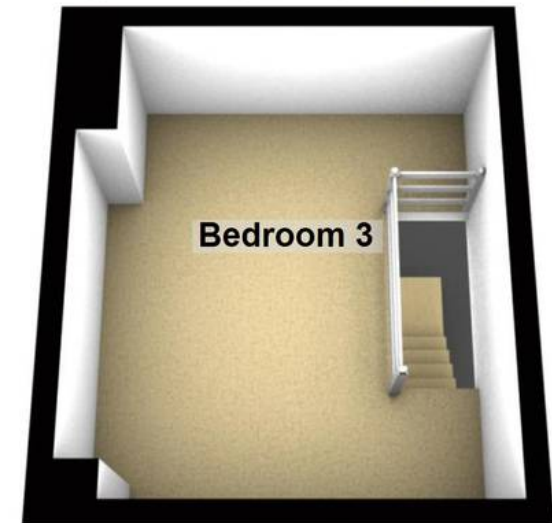

Total area: approx. 78.7 sq. metres (847.0 sq. feet)



WHITEHORNES

Buy. Sell. Let. Relax!

0114 268 8533
info@whitehorns.com
www.whitehorns.com